

Parts List

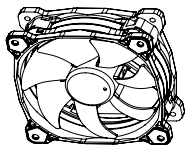

A x 3
Fan

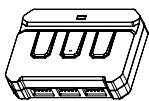

B x 1
Controller

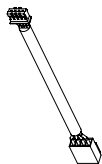

C x 1
Controller Cable



D x 12
Short Screw



E x 12
Long Screw



F x 1
Velcro

Installation Guide

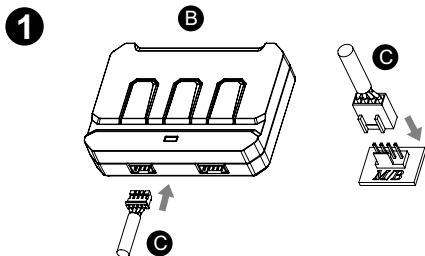

Connect the 4pin controller cable to mainboard and Controller.

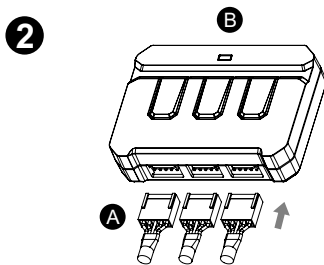

Always insert the 5pin fan cable into the primary connector on the controller (Note: There is a mark printed on the primary connector)

Controller

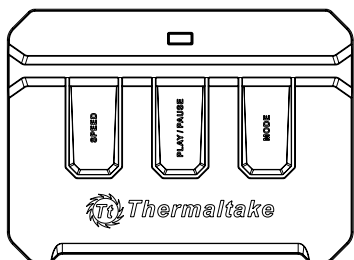

SPEED : Switch over between 2 fan speed modes
LED Indicator shows Blue: Normal mode 800~1500rpm
LED Indicator shows Red: Low noise mode 400~1000rpm

PLAY/PAUSE : When you switch to 256 colors mode, click to memorize and lock the color you want, click again to unlock the 256 colors auto rotation

MODE : Switch over between 6 LED modes
Red → Blue → White → Green → LED off → 256 colors

